

Ring Terminal with Insulation

Krallenkabelschuhe Mit Kunststoffülse

Prise Anneau Avec Isolation



RING
3-10

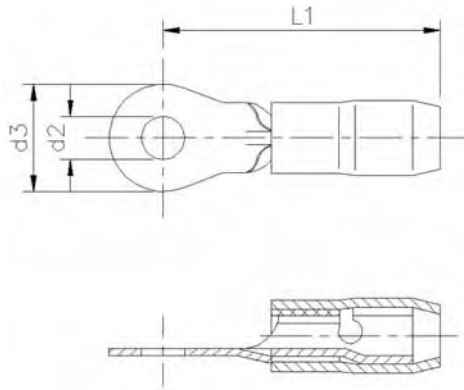

Type	Wire Range	d2	d3	L1	Mat	Max. Ins Thickness	Part	Material Number	Carton	Colour Size
Typ	Nenniger Schnitt				Mat.	Max-Ins Stärke	Best nr	Werkstoff	Menge pro	Farbe Karton
Type	Section Range				Epaisseur	Max-Ins Épaisseur	Code nr	Matière	Cartons à	Couleur
1	0.5-1	3.20	8.00	20.50	0.6	E	UTX33935-N01	PVC, Se-Cu Sn 3	1500	Red
1	0.5-1	4.30	8.00	20.50	0.6	E	UTX31735-N01	PVC, Se-Cu Sn 3	1500	Red
1	0.5-1	5.30	8.00	20.50	0.6	E	UTX33938-N01	PVC, Se-Cu Sn 3	1500	Red
1	1.5-2.5	3.20	8.00	20.50	0.6	E	UTX33936-N01	PVC, Se-Cu Sn 3	1250	Blue
1	1.5-2.5	4.30	8.00	20.50	0.6	E	UTX31736-N01	PVC, Se-Cu Sn 3	1250	Blue
1	1.5-2.5	5.30	9.50	21.25	0.6	E	UTX31737-N01	PVC, Se-Cu Sn 3	1250	Blue
1	1.5-2.5	6.40	9.50	21.25	0.6	E	UTX33937-N01	PVC, Se-Cu Sn 3	1250	Blue
1	4-6	5.30	9.50	21.25	0.8	E	UTX31738-N01	PVC, Se-Cu Sn 3	800	Yellow
1	4-6	6.40	12.50	22.75	0.8	E	UTX31739-N01	PVC, Se-Cu Sn 3	750	Yellow
1	4-6	8.50	12.50	22.75	0.8	E	UTX32643-N01	PVC, Se-Cu Sn 3	600	Yellow
1	4-6	10.50	18.50	25.75	0.8	E	UTX31740-N01	PVC, Se-Cu Sn 3	500	Yellow

Germany +49 (0) 202 460 3468

Europe +421 43 583 1311

United Kingdom +44 (0) 1986 891516



making the connection



FM 09860

8.0 - 3.7

Cable Lug Ring Type Brazed with Insulation Sleeve

Kabelschuhe Ringform Gelötet Mit Kunststofffülse

Crouchet de Câble Type Anneau, Soudé Avec Protection Isolante



RING
2-10

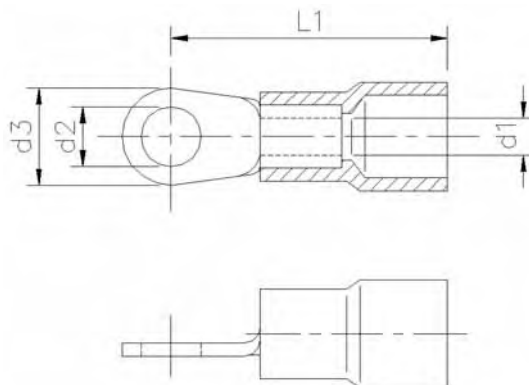

Type	Wire Range	DIN	Nom. Size	d1	d2	d3	L1	Mat Thickness	E=Single B=Chain	Part Number	Material	Carton Size	Colour
Typ	Nennquerschnitt	DIN	Nom. Größe	d1	d2	d3	L1	Mat. dicke	E=Einzel B=Kette	Best nr	Werkstoff	Menge pro Karton	Farbe
Type	Section Range	DIN	Nom. Taille	d1	d2	d3	L1	Epaisseur matériau	E=Simple B=Chaîne	Code nr	Matière	Cartons à	Couleur

Cable Lug Ring Type Brazed with Insulation Sleeve

1	0.5-1	46237 FORM B	2.5-1	1.6	2.80	6.00	16	0.80	E	UTX33500-N01	SE-Cu PA	2000	Red
1	0.5-1	46237 FORM B	3-1	1.6	3.20	6.00	16	0.80	E	UTX33501-N01	SE-Cu PA	2000	Red
1	0.5-1	46237 FORM B	3.5-1	1.6	3.70	6.00	16	0.80	E	UTX33502-N01	SE-Cu PA	2000	Red
1	0.5-1	46237 FORM B	4-1	1.6	4.30	8.00	17	0.80	E	UTX33503-N01	SE-Cu PA	1750	Red
1	0.5-1	46237 FORM B	5-1	1.6	5.30	10.00	18	0.80	E	UTX33504-N01	SE-Cu PA	1500	Red
1	0.5-1		6-1	1.6	6.50	11.00	20	0.80	E	UTX33572-N01	SE-Cu PA	1500	Red
1	0.5-1		8-1	1.6	8.40	14.00	22	0.80	E	UTX33573-N01	SE-Cu PA	1000	Red
1	0.5-1		10-1	1.6	10.50	18.00	24	0.80	E	UTX33574-N01	SE-Cu PA	750	Red
1	1.5-2.5	46237 FORM B	3-2.5	2.3	3.20	6.00	17	0.80	E	UTX33505-N01	SE-Cu PA	1500	Blue
1	1.5-2.5	46237 FORM B	3.5-2.5	2.3	3.70	6.00	17	0.80	E	UTX33561-N01	SE-Cu PA	1500	Blue
1	1.5-2.5	46237 FORM B	4-2.5	2.3	4.30	8.00	18	0.80	E	UTX33506-N01	SE-Cu PA	1250	Blue
1	1.5-2.5	46237 FORM B	5-2.5	2.3	5.30	10.00	20	0.80	E	UTX33507-N01	SE-Cu PA	1250	Blue
1	1.5-2.5	46237 FORM B	6-2.5	2.3	6.50	11.00	22	0.80	E	UTX33508-N01	SE-Cu PA	1000	Blue
1	1.5-2.5	46237 FORM B	8-2.5	2.3	8.40	14.00	23	0.80	E	UTX33509-N01	SE-Cu PA	800	Blue
1	1.5-2.5		10-2.5	2.3	10.50	18.00	25	0.80	E	UTX33575-N01	SE-Cu PA	600	Blue

Germany +49 (0) 202 460 3468

Europe +421 43 583 1311

United Kingdom +44 (0) 1986 891516



making the connection



FM 09860

8.0 - 3.9

Cable Lug Ring Type Brazed with Insulation Sleeve

Kabelschuhe Ringform Gelötet Mit Kunststofffülse

Crouchet de Câble Type Anneau, Soudé Avec Protection Isolante



RING
2-10

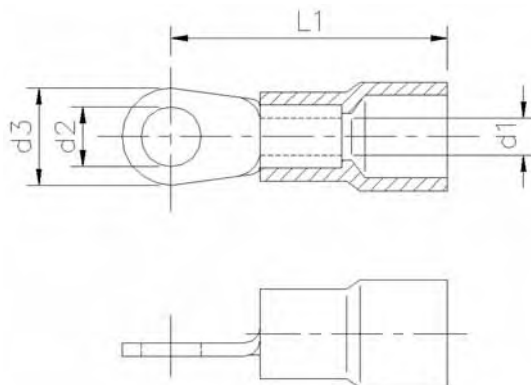

Type	Wire Range	DIN	Nom. Size	d1	d2	d3	L1	Mat Thickness	E=Single B=Chain	Part Number	Material	Carton Size	Colour
Typ	Nennquerschnitt	DIN	Nom. Größe	d1	d2	d3	L1	Mat. dicke	E=Einzel B=Kette	Best nr	Werkstoff	Menge pro Karton	Farbe
Type	Section Range	DIN	Nom. Taille	d1	d2	d3	L1	Epaisseur matériau	E=Simple B=Chaîne	Code nr	Matière	Cartons à	Couleur

Cable Lug Ring Type with Insulation Sleeve

1	0.5-1		3-1	1.6	2.80	6.00	16	0.80	E	UTX39801-N01	SE-Cu PA	2000	Red
1	0.5-1		3.5-1	1.6	3.20	6.00	16	0.80	E	UTX39802-N01	SE-Cu PA	2000	Red
1	0.5-1		4-1	1.6	3.70	6.00	16	0.80	E	UTX39803-N01	SE-Cu PA	2000	Red
1	0.5-1		5-1	1.6	4.30	8.00	17	0.80	E	UTX39804-N01	SE-Cu PA	1750	Red
1	0.5-1		6-1	1.6	5.30	10.00	18	0.80	E	UTX39872-N01	SE-Cu PA	1500	Red
1	0.5-1		8-1	1.6	6.50	11.00	20	0.80	E	UTX39873-N01	SE-Cu PA	1500	Red
1	0.5-1		10-1	1.6	8.40	14.00	22	0.80	E	UTX39874-N01	SE-Cu PA	1000	Red
1	1.5-2.5		3-2.5	1.6	10.50	18.00	24	0.80	E	UTX39805-N01	SE-Cu PA	750	Blue
1	1.5-2.5		3.5-2.5	2.3	3.20	6.00	17	0.80	E	UTX39861-N01	SE-Cu PA	1500	Blue
1	1.5-2.5		4-2.5	2.3	3.70	6.00	17	0.80	E	UTX39806-N01	SE-Cu PA	1500	Blue
1	1.5-2.5		5-2.5	2.3	4.30	8.00	18	0.80	E	UTX39807-N01	SE-Cu PA	1250	Blue
1	1.5-2.5		6-2.5	2.3	5.30	10.00	20	0.80	E	UTX39808-N01	SE-Cu PA	1250	Blue
1	1.5-2.5		8-2.5	2.3	6.50	11.00	22	0.80	E	UTX39809-N01	SE-Cu PA	1000	Blue
1	1.5-2.5		10-2.5	2.3	8.40	14.00	23	0.80	E	UTX39875-N01	SE-Cu PA	800	Blue
1	4-6		4-6	2.3	10.50	18.00	25	0.80	E	UTX39810-N01	SE-Cu PA	600	Yellow
1	4-6		5-6	3.6	4.30	8.00	20	1.00	E	UTX39811-N01	SE-Cu PA	800	Yellow
1	4-6		6-6	3.6	5.30	10.00	21	1.00	E	UTX39812-N01	SE-Cu PA	750	Yellow
1	4-6		8-6	3.6	6.50	11.00	22	1.00	E	UTX39813-N01	SE-Cu PA	750	Yellow
1	4-6		10-6	3.6	8.40	14.00	25	1.00	E	UTX39814-N01	SE-Cu PA	600	Yellow

Germany +49 (0) 202 460 3468

Europe +421 43 583 1311

United Kingdom +44 (0) 1986 891516



making the connection



FM 09860

8.0 - 4.1