

# Flag Receptacles

## Winkel-Flachsteckhülse

## Clips Drapeaux



6.3  
x 0.8

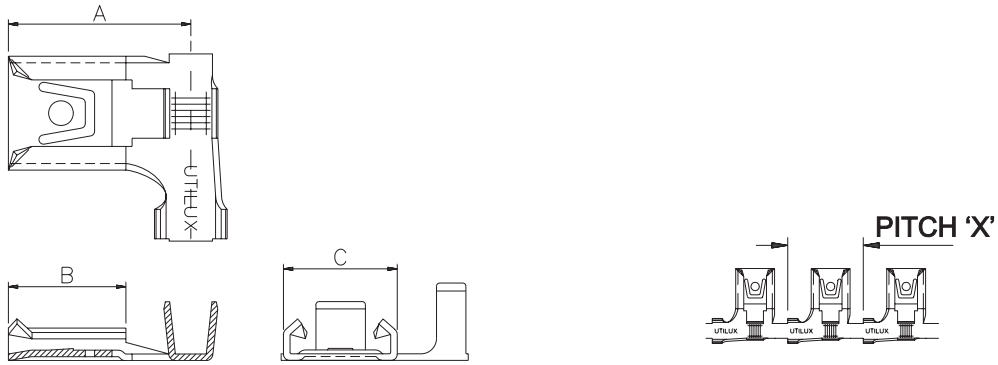

Wire Range	Max.Ins	Tab Thickness	Mat Thickness	Material	A	B	C	X	Reel Size	Carton Size	Part Number	Approvals
Nennquerschnitt	Stift	Steckerdicke	Mat.dicke	Werkstoff	A	B	C	X	Spulen größe	Menge pro karton	Best Nr	Zulassungen
Section câble	Gaine	Epaisseur languette	Epaisseur matériau	Matériau					Bobines à	Cartons à	Code Nr	Homologations
0.22-1.0	3.2	0.8	0.425	CuZn	11.8	7.6	7.4	14.3	6K	18K	63FR08-10AB	
0.22-1.0	3.2	0.8	0.425	CuZn gal Sn	11.8	7.6	7.4	14.3	6K	18K	63FR08-10AC	
0.22-1.0	3.2	0.8	0.425	CuNi Zn	11.8	7.6	7.4	14.3	6K	18K	63FR08-10AD	
0.22-1.0	3.2	0.8	0.425	St gal Ni	11.8	7.6	7.4	14.3	6K	18K	63FR08-10AE	
0.22-1.0	3.2	0.8	0.425	CuSn	11.8	7.6	7.4	14.3	6K	18K	63FR08-10AA	

Germany +49 (0) 202 460 3468

Europe +421 43 583 1311

United Kingdom +44 (0) 1986 891516



making the connection



FM 09860

3.0 - 1.7

# Flag Receptacles

## Winkel-Flachsteckhülse

## Clips Drapeaux



6.3

x 0.8  
x 1.0

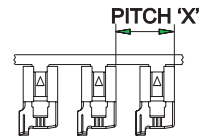
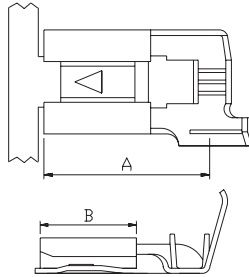

Wire Range	Max.Ins	Tab Thickness	Mat Thickness	Material	A	B	C	X	Reel Size	Carton Size	Part Number	Approvals
Nennquerschnitt	Stift	Steckerdicke	Mat.dicke	Werkstoff	A	B	C	X	Spulen größe	Menge pro karton	Best Nr	Zulassungen
Section câble	Gaine	Epaisseur languette	Epaisseur matériau	Matériau					Bobines à	Cartons à	Code Nr	Homologations

0.7-2.1	4.0	0.8	0.45	CuZn	11.8	7.6	7.4	17.3	2K	16K	63FR08-10GB	UL
0.7-2.1	4.0	0.8	0.45	CuZn gal Sn	11.8	7.6	7.4	17.3	2K	16K	63FR08-10GC	UL
0.7-2.1	4.0	0.8	0.45	CuNi Zn	11.8	7.6	7.4	17.3	2K	16K	63FR08-10GD	UL
0.7-2.1	4.0	0.8	0.45	St gal Ni	11.8	7.6	7.4	17.3	2K	16K	63FR08-10GE	
0.7-2.1	4.0	0.8	0.45	CuSn	11.8	7.6	7.4	17.3	2K	16K	63FR08-10GA	
0.3-1.0	3.2	0.8	0.40	CuZn	11.8	7.6	7.4	17.3	2.5K	20K	63FR08-10LB	
0.3-1.0	3.2	0.8	0.40	CuZn gal Sn	11.8	7.6	7.4	17.3	2.5K	20K	63FR08-10LC	
0.3-1.0	3.2	0.8	0.40	CuNi Zn	11.8	7.6	7.4	17.3	2.5K	20K	63FR08-10LD	
0.3-1.0	3.2	0.8	0.40	St gal Ni	11.8	7.6	7.4	17.3	2.5K	20K	63FR08-10LE	
0.3-1.0	3.2	0.8	0.40	CuSn	11.8	7.6	7.4	17.3	2.5K	20K	63FR08-10LA	
0.7-2.1	4.0	0.8	0.40	CuZn	11.8	7.6	7.4	17.3	2K	16K	63FR08-30GB	
0.7-2.1	4.0	0.8	0.40	CuZn gal Sn	11.8	7.6	7.4	17.3	2K	16K	63FR08-30GC	
0.7-2.1	4.0	0.8	0.40	CuNi Zn	11.8	7.6	7.4	17.3	2K	16K	63FR08-30GD	
0.7-2.1	4.0	0.8	0.40	St gal Ni	11.8	7.6	7.4	17.3	2K	16K	63FR08-30GE	
0.7-2.1	4.0	0.8	0.40	CuSn	11.8	7.6	7.4	17.3	2K	16K	63FR08-30GA	
0.7-2.1	4.0	1.0	0.40	CuZn gal Sn	19.1	7.8	7.8	17.3	2K	16K	63FR10-30GC	

### 2-Wire, Double Insulation Leg

0.4-1.0x2	3.3x2	0.8	0.45	CuZn	11.8	7.6	7.4	15.4	3K	9K	63FR08-12CB	UL
0.4-1.0x2	3.3x2	0.8	0.45	CuZn gal Sn	11.8	7.6	7.4	15.4	3K	9K	63FR08-12CC	UL
0.4-1.0x2	3.3x2	0.8	0.45	CuNi Zn	11.8	7.6	7.4	15.4	3K	9K	63FR08-12CD	UL
0.4-1.0x2	3.3x2	0.8	0.45	St gal Ni	11.8	7.6	7.4	15.4	3K	9K	63FR08-12CE	
0.4-1.0x2	3.3x2	0.8	0.45	CuSn	11.8	7.6	7.4	15.4	3K	9K	63FR08-12CA	UL

Germany +49 (0) 202 460 3468

Europe +421 43 583 1311

United Kingdom +44 (0) 1986 891516



making the connection



3.0 - 1.8

# Flag Receptacles

## Winkel Flachsteckhülse

## Clips Drapeaux



6.3  
x 0.8

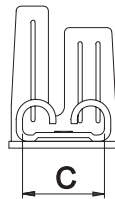
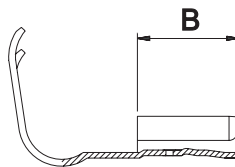
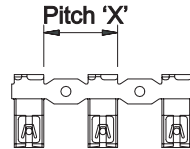
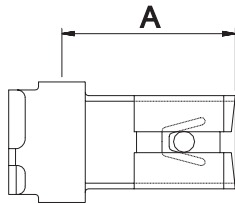

DIMENSIONALLY  
CONFORMS TO  
DIN 46 346

### MATING FORCES

1st Insertion	50N max	10th Withdrawal	20N min
---------------	---------	-----------------	---------

Wire Range	Max.Ins	Tab Thickness	Mat Thickness	Material	A	B	C	X	Reel Size	Carton Size	Part Number	Approvals
Nennquerschnitt	Stift	Steckerdicke	Mat.dicke	Werkstoff	A	B	C	X	Spulen grösse	Menge pro karton	Best Nr	Zulassungen
Section câble	Gaine	Epaisseur languette	Epaisseur matériau	Matériau					Bobines à	Cartons à	Code Nr	Homologations

0.5-1.0	2.9	0.8	0.425	CuZn	11.8	7.5	6.6	19.0	6K	18K	63FR08-10DB	
0.5-1.0	2.9	0.8	0.425	CuZn gal Sn	11.8	7.5	6.6	19.0	6K	18K	63FR08-10DC	
0.5-1.0	2.9	0.8	0.425	CuSn	11.8	7.5	6.6	19.0	6K	18K	63FR08-10DA	
0.5-1.0	2.9	0.8	0.425	CuSn gal Sn	11.8	7.5	6.6	19.0	6K	18K	63FR08-10DG	
0.5-1.0	2.9	0.8	0.425	CuNi Zn	11.8	7.5	6.6	19.0	6K	18K	63FR08-10DD	
0.5-1.0	2.9	0.8	0.425	St gal Ni	11.8	7.5	6.6	19.0	6K	18K	63FR08-10DE	
1.0-2.5	3.3	0.8	0.425	CuZn	12.8	7.5	6.6	19.0	6K	18K	63FR08-10HB	
1.0-2.5	3.3	0.8	0.425	CuZn gal Sn	12.8	7.5	6.6	19.0	6K	18K	63FR08-10HC	
1.0-2.5	3.3	0.8	0.425	CuSn	12.8	7.5	6.6	19.0	6K	18K	63FR08-10HA	
1.0-2.5	3.3	0.8	0.425	CuSn gal Sn	12.8	7.5	6.6	19.0	6K	18K	63FR08-10HG	
1.0-2.5	3.3	0.8	0.425	CuNi Zn	12.8	7.5	6.6	19.0	6K	18K	63FR08-10HD	
1.0-2.5	3.3	0.8	0.425	St gal Ni	12.8	7.5	6.6	19.0	6K	18K	63FR08-10HE	

Germany +49 (0) 202 460 3468

Europe +421 43 583 1311

United Kingdom +44 (0) 1986 891516



making the connection



FM 09860

3.0 - 1.9

# Flag Receptacles, Low Insertion

Wilkel Flachsteckhülse

Steckkraftreduziert

Clips Drapeaux, Insertion Basse



6.3  
x 0.8

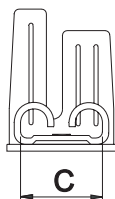
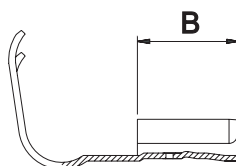
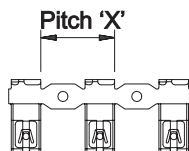
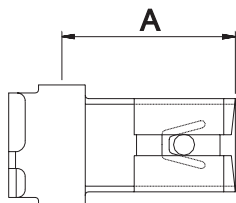

DIMENSIONALLY  
CONFORMS TO  
DIN 46 346

MATING FORCES			
1st Insertion	35N max	10th Withdrawal	20N min

Wire Range	Max.Ins	Tab Thickness	Mat Thickness	Material	A	B	C	X	Reel Size	Carton Size	Part Number	Approvals
Nennquerschnitt	Stift	Steckerdicke	Mat.dicke	Werkstoff	A	B	C	X	Spulen größe	Menge pro karton	Best Nr	Zulassungen
Section câble	Gaine	Epaisseur languette	Epaisseur matériau	Matériau					Bobines à	Cartons à	Code Nr	Homologations

0.5-1.0	2.9	0.8	0.425	CuZn	11.8	7.5	6.6	19.0	6K	18K	63FR08-20DB	
0.5-1.0	2.9	0.8	0.425	CuZn gal Sn	11.8	7.5	6.6	19.0	6K	18K	63FR08-20DC	
0.5-1.0	2.9	0.8	0.425	CuSn	11.8	7.5	6.6	19.0	6K	18K	63FR08-20DA	
0.5-1.0	2.9	0.8	0.425	CuSn gal Sn	11.8	7.5	6.6	19.0	6K	18K	63FR08-20DG	
0.5-1.0	2.9	0.8	0.425	CuNi Zn	11.8	7.5	6.6	19.0	6K	18K	63FR08-20DD	
0.5-1.0	2.9	0.8	0.425	St gal Ni	11.8	7.5	6.6	19.0	6K	18K	63FR08-20DE	
1.0-2.5	3.3	0.8	0.425	CuZn	12.8	7.5	6.6	19.0	6K	18K	63FR08-20HB	
1.0-2.5	3.3	0.8	0.425	CuZn gal Sn	12.8	7.5	6.6	19.0	6K	18K	63FR08-20HC	
1.0-2.5	3.3	0.8	0.425	CuSn	12.8	7.5	6.6	19.0	6K	18K	63FR08-20HA	
1.0-2.5	3.3	0.8	0.425	CuSn gal Sn	12.8	7.5	6.6	19.0	6K	18K	63FR08-20HG	
1.0-2.5	3.3	0.8	0.425	CuNi Zn	12.8	7.5	6.6	19.0	6K	18K	63FR08-20HD	
1.0-2.5	3.3	0.8	0.425	St gal Ni	12.8	7.5	6.6	19.0	6K	18K	63FR08-20HE	

Germany +49 (0) 202 460 3468

Europe +421 43 583 1311

United Kingdom +44 (0) 1986 891516



making the connection



FM 09860

3.0 - 2.0

# Flag Receptacles, Locking, Din

Gerade Flachsteckhülse  
B-Crimp Din 46346

Prises Drapeaux,  
Avec Verrouillage, Din



6.3  
x 0.8

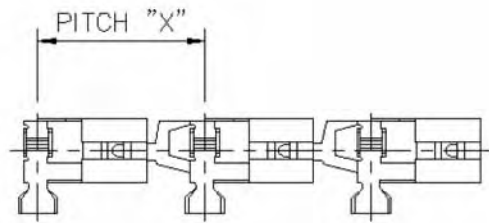
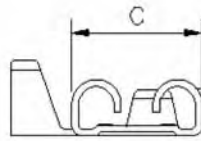
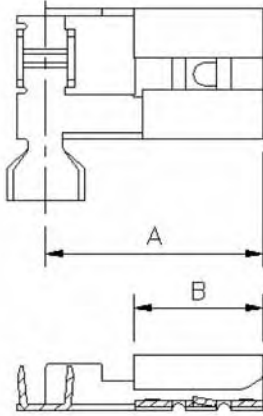

Wire Range	Max.Ins	Tab Thickness	Mat Thickness	Material	A	B	C	X	Reel Size	Carton Size	Part Number	Approvals
Nennquerschnitt	Stift	Steckerdicke	Mat.dicke	Werkstoff	A	B	C	X	Spulen größe	Menge pro karton	Best Nr	Zulassungen
Section câble	Gaine	Epaisseur languette	Epaisseur matériau	Matériau					Bobines à	Cartons à	Code Nr	Homologations

## DIN 6.3 Flag Terminal with B Crimp

0.5 - 1.0	-	0.8	0.38	CuSn	12.5	7.4	7.3	19.2	3K	9K	63FR08-10DA-B	
0.5 - 1.0	-	0.8	0.38	CuZn	12.5	7.4	7.3	19.2	3K	9K	63FR08-10DB-B	
0.5 - 1.0	-	0.8	0.38	CuZn gal Sn	12.5	7.4	7.3	19.2	3K	9K	63FR08-10DC-B	
0.5 - 1.0	-	0.8	0.38	CuSn gal Sn	12.5	7.4	7.3	19.2	3K	9K	63FR08-10DG-B	
1.0 - 2.5	-	0.8	0.38	CuSn	13.9	7.4	7.3	21.2	3K	9K	63FR08-10HA-B	
1.0 - 2.5	-	0.8	0.38	CuZn	13.9	7.4	7.3	21.2	3K	9K	63FR08-10HB-B	
1.0 - 2.5	-	0.8	0.38	CuZn gal Sn	13.9	7.4	7.3	21.2	3K	9K	63FR08-10HC-B	
1.0 - 2.5	-	0.8	0.38	CuSn gal Sn	13.9	7.4	7.3	21.2	3K	9K	63FR08-10HG-B	

Germany +49 (0) 202 460 3468

Europe +421 43 583 1311

United Kingdom +44 (0) 1986 891516



making the connection



FM 09860

3.0 - 2.1

# Flag Receptacles, Locking

Gerade Flachsteckhülse Verriegelbar

Clips Drapeaux, Avec Verrouillage



6.3  
x 0.8

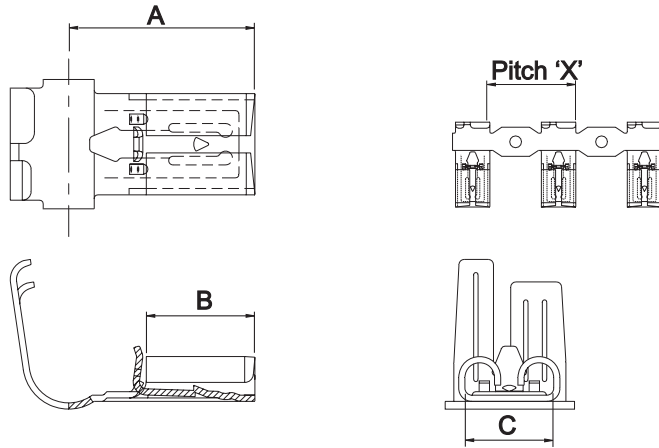

DIMENSIONALLY  
CONFORMS  
TO DIN 46 346

Wire Range	Max.Ins	Tab Thickness	Mat Thickness	Material	A	B	C	X	Reel Size	Carton Size	Part Number	Approvals
Nennquerschnitt	Stift	Steckerdicke	Mat.dicke	Werkstoff	A	B	C	X	Spulen grösse	Menge pro karton	Best Nr	Zulassungen
Section câble	Gaine	Epaisseur languette	Epaisseur matériau	Matériau					Bobines à	Cartons à	Code Nr	Homologations

0.5-1.0	2.9	0.8	0.425	CuZn	11.8	7.5	6.6	19.0	6K	18K	63FL08-10DB	
0.5-1.0	2.9	0.8	0.425	CuZn gal Sn	11.8	7.5	6.6	19.0	6K	18K	63FL08-10DC	
0.5-1.0	2.9	0.8	0.425	CuSn	11.8	7.5	6.6	19.0	6K	18K	63FL08-10DA	
0.5-1.0	2.9	0.8	0.425	CuSn gal Sn	11.8	7.5	6.6	19.0	6K	18K	63FL08-10DG	
0.5-1.0	2.9	0.8	0.425	CuNi Zn	11.8	7.5	6.6	19.0	6K	18K	63FL08-10DD	
0.5-1.0	2.9	0.8	0.425	St gal Ni	11.8	7.5	6.6	19.0	6K	18K	63FL08-10DE	
1.0-2.5	3.3	0.8	0.425	CuZn	12.8	7.5	6.6	19.0	6K	18K	63FL08-10HB	
1.0-2.5	3.3	0.8	0.425	CuZn gal Sn	12.8	7.5	6.6	19.0	6K	18K	63FL08-10HC	
1.0-2.5	3.3	0.8	0.425	CuSn	12.8	7.5	6.6	19.0	6K	18K	63FL08-10HA	
1.0-2.5	3.3	0.8	0.425	CuSn gal Sn	12.8	7.5	6.6	19.0	6K	18K	63FL08-10HG	
1.0-2.5	3.3	0.8	0.425	CuNi Zn	12.8	7.5	6.6	19.0	6K	18K	63FL08-10HD	
1.0-2.5	3.3	0.8	0.425	St gal Ni	12.8	7.5	6.6	19.0	6K	18K	63FL08-10HE	

Germany +49 (0) 202 460 3468

Europe +421 43 583 1311

United Kingdom +44 (0) 1986 891516



making the connection



3.0 - 2.2